

4 LOW HEADROOM HOIST NC, REEVING: 02

Hoist dimensions

HOL m	Length code	M1 mm	H2 mm	H3 mm	H3* mm	BUF mm	Weight kg
12	B	356	95	568	584	524	325
18	C	456	144	568	584	624	345
24	D	556	193	568	584	724	365

Motor dimensions

Motor	P3	P4	A3	S3	S5
MOT (mm)	473	574	443	523	602
Weight (kg)	35	53	32	28	53

Trolley dimensions

B min.	B max.	ØWD	ØBU	BU	BUH	E1	E2	GEA	H1	H4	TD
100	490	100	63	168	42	8	628	116	258	536	203
TF	TH	TW									
45	241	38									

D002087_A
001576

C-dimensions

B	C
100 - 250	440
251 - 300	470
301 - 350	505
351 - 400	535
401 - 450	570
451 - 490	595

Note: All dimensions in mm.

Note: Weight calculated with P3 motor.

Note: Motor S5 is unavailable for load class 3200 kg.

* Please, disregard the dimension H3*.

Low Headroom Hoist NC, REEVING: 02

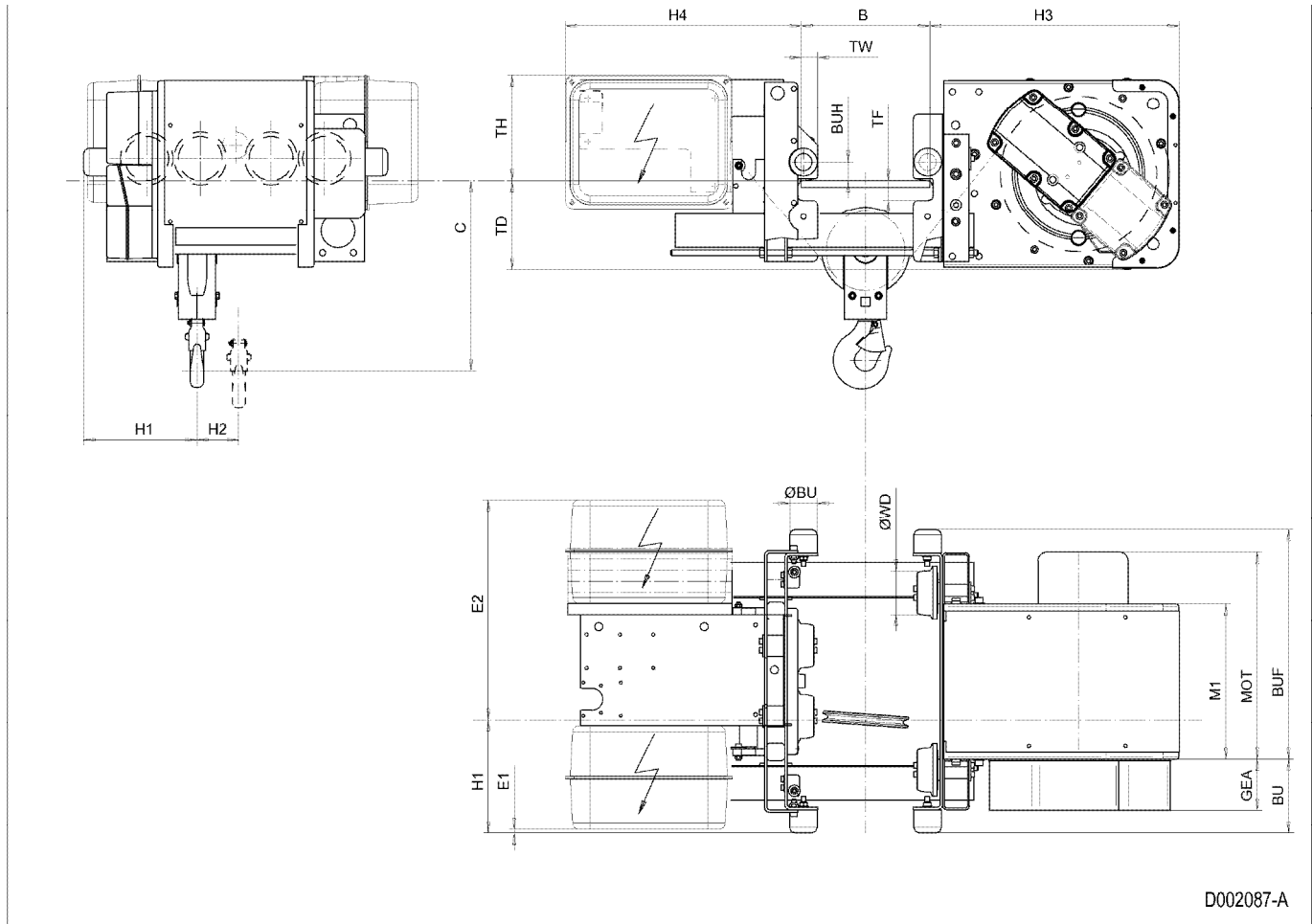

D002087-A