

## 80 FIXED HOIST NB, REEVING: 04

### Hoist dimensions

HOL m	Length code	M1 mm	H2 mm	H3 mm	H3* mm	R mm	Weight kg
6	A	326	45	461	476	400	130
9.5	C	456	72	461	476	530	140

### Motor dimensions

Motor	P1	P2	P3	A3	S3
MOT (mm)	386	446	476	446	526
Weight (kg)	21	31	35	32	28

### Trolley dimensions

C	ØF	E3	F1	F3	GEA	H1	H4	M2	RO	TH	
145	18	78	113	100	110	182	378	37	25	395	

D002078\_A  
062132

Note: All dimensions in mm.

Note: Weight calculated with P1 motor.

\* Please, disregard the dimension H3\*.

Fixed Hoist NB, REEVING: 04

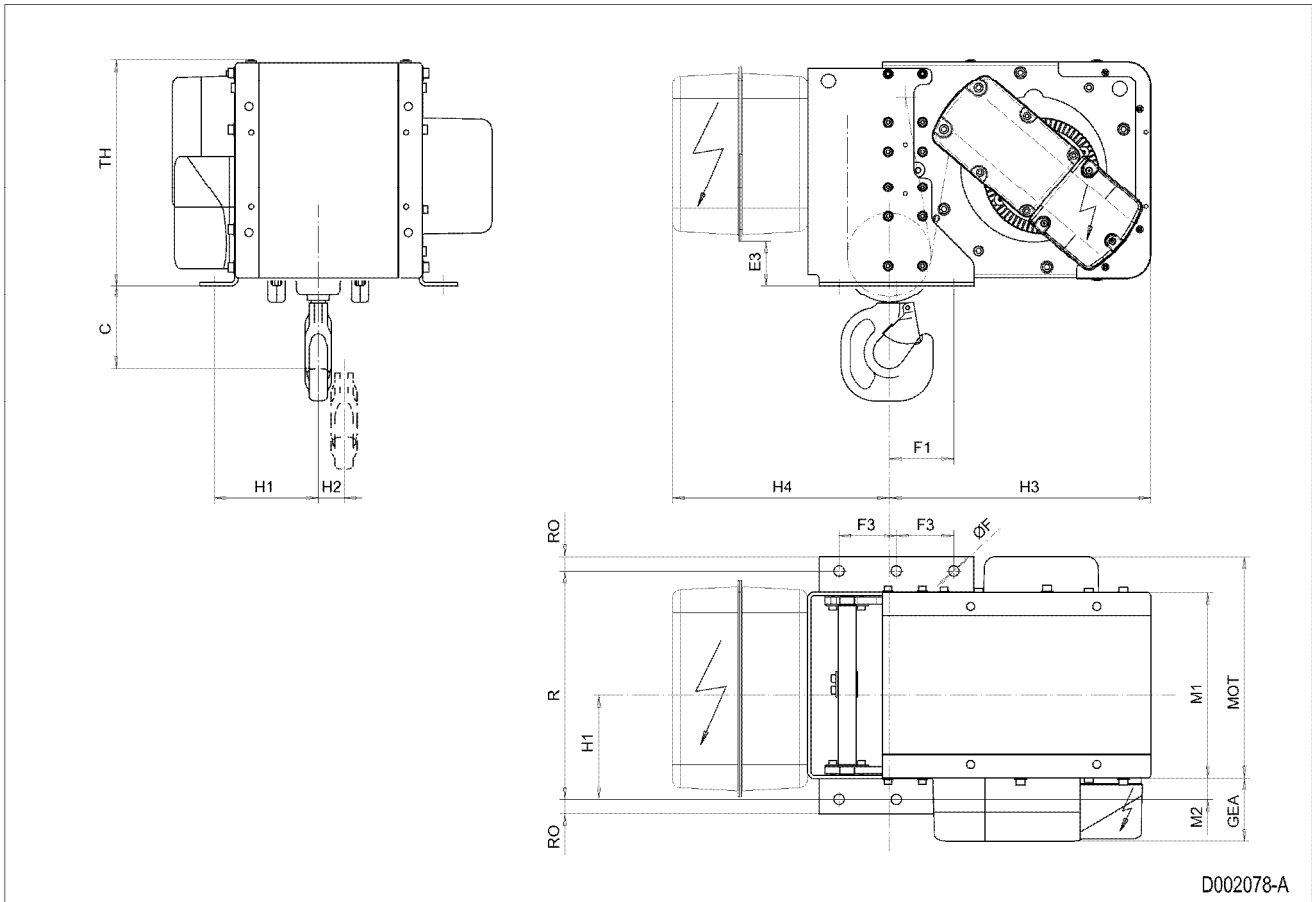

D002078-A